

Solid Wall Insulation System

Wall-Reform II External Wall Insulation

High Performance External Insulated Panel & Render System

Suitable for use on all substrates:

- ▶ Solid Wall
- ▶ System Built
- ▶ Traditional
- ▶ Steel/Concrete Timber Frame

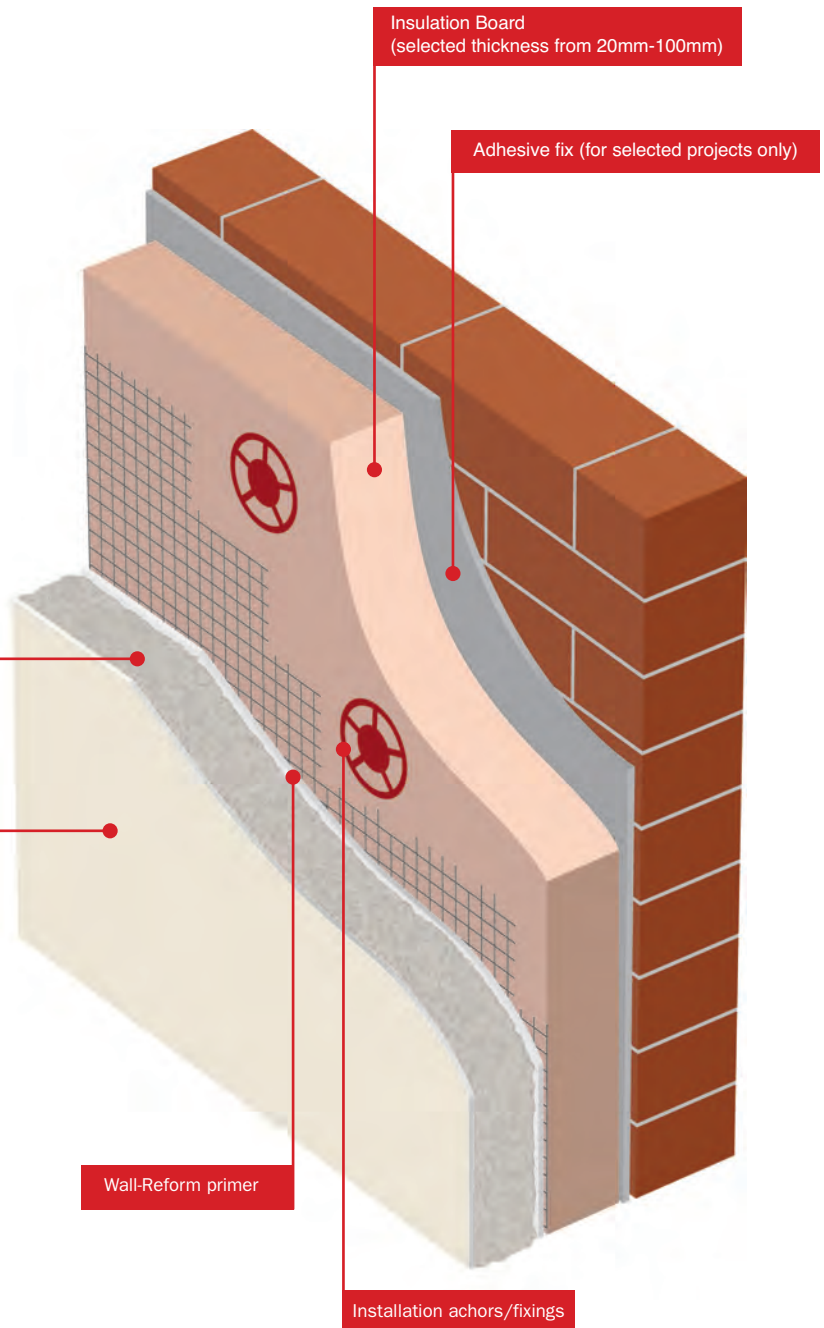

U-values Typical Construction Format for 215mm brickwork

Allowing for a consistent 15mm Wall-Reform and 2mm acrylic/silicone finish

Un-insulated: 2.10W/m².k

Resultant value with:

20mm EWb: 0.61 W/m ² .k	70mm EWb: 0.24 W/m ² .k
30mm EWb: 0.47 W/m ² .k	80mm EWb: 0.22 W/m ² .k
40mm EWb: 0.39 W/m ² .k	90mm EWb: 0.20 W/m ² .k
50mm EWb: 0.31 W/m ² .k	100mm EWb: 0.18 W/m ² .k
60mm EWb: 0.27 W/m ² .k	

1 Boards Applied



2 Wall-Reform Applied



3 Finished



Increased Benefits with Wall-Reform II

- All benefits of Wall-Reform System I External
- BBA certification for Wall-Reform System II
- Meets stringent government set building standards
- An un-insulated solid wall has a U-value of 2.1 with this system U-value will reach 0.30 new build regulations acceptable for the whole of the UK

Climate Energy Solutions Ltd

Unit 4, Tamdown Way, Springwood Industrial Estate, Braintree, Essex, CM7 2QL

Tel: 0800 980 4749

Email: info@wallreform.co.uk

ce-solutions.co.uk

